

FROM DREAM TO REALITY: *Pat & Tom Foley's log home journey*

In 2001, Pat & Tom Foley hadn't thought much about building a log home. But their son Tommy, a firefighter in NYC, owned land in Ulster County, NY and had dreamed about building a log home on it one day. On September 11, 2001, Tommy lost his life on the attacks on the World Trade Centers. From that day on, Pat and Tom decided to build a log home on that piece of property in honor of their son and hero.

Today they have a gorgeous 3,400 sq. ft. Beaver Mountain home with 4 bedrooms and 2 bathrooms constructed by Jim Stevenson and his son Scott. It is ideal for entertaining; the gourmet kitchen is centrally

Continued on inside...





...Foley Home continued

located, linking the great room to the dining room. Spacious decks provide outdoor space for gatherings and BBQs.

But the heart of this home lies around the great stone fireplace where many of Tommy's awards, bull riding trophies, prize deer mounts and family mementos are held. It is proof that he still lives on, in the memory of those who love him and were blessed to know him.

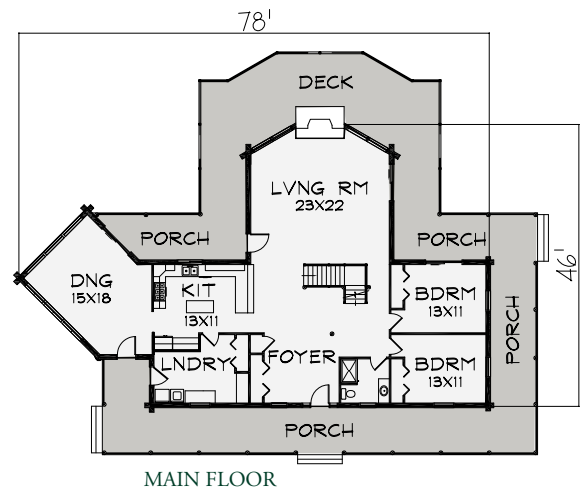
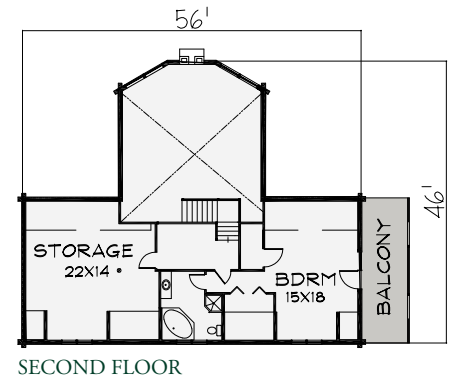

The Builders:
Jim & Scott Stevenson

"Since we began building Beaver Mountain Homes in 1988, we have constructed over 45 homes. The pre-cutting and preparation of the logs and timbers makes my job easier in the field and the homes extremely well built."





We are so thankful to have placed our trust in your company to build our log home. Peter, John and Mike, who worked with us to design and build our home were wonderful and so knowledgeable.

Our home is magnificent and we are enjoying every minute we spend here. Everyone that sees this log home is overwhelmed by its beauty and comments on the fine detail that went into building it. Jim Stevenson and his crew did a fabulous job erecting this Beaver Mountain home.

Thank you, again, for all your hard work.

Pat & Tom

